

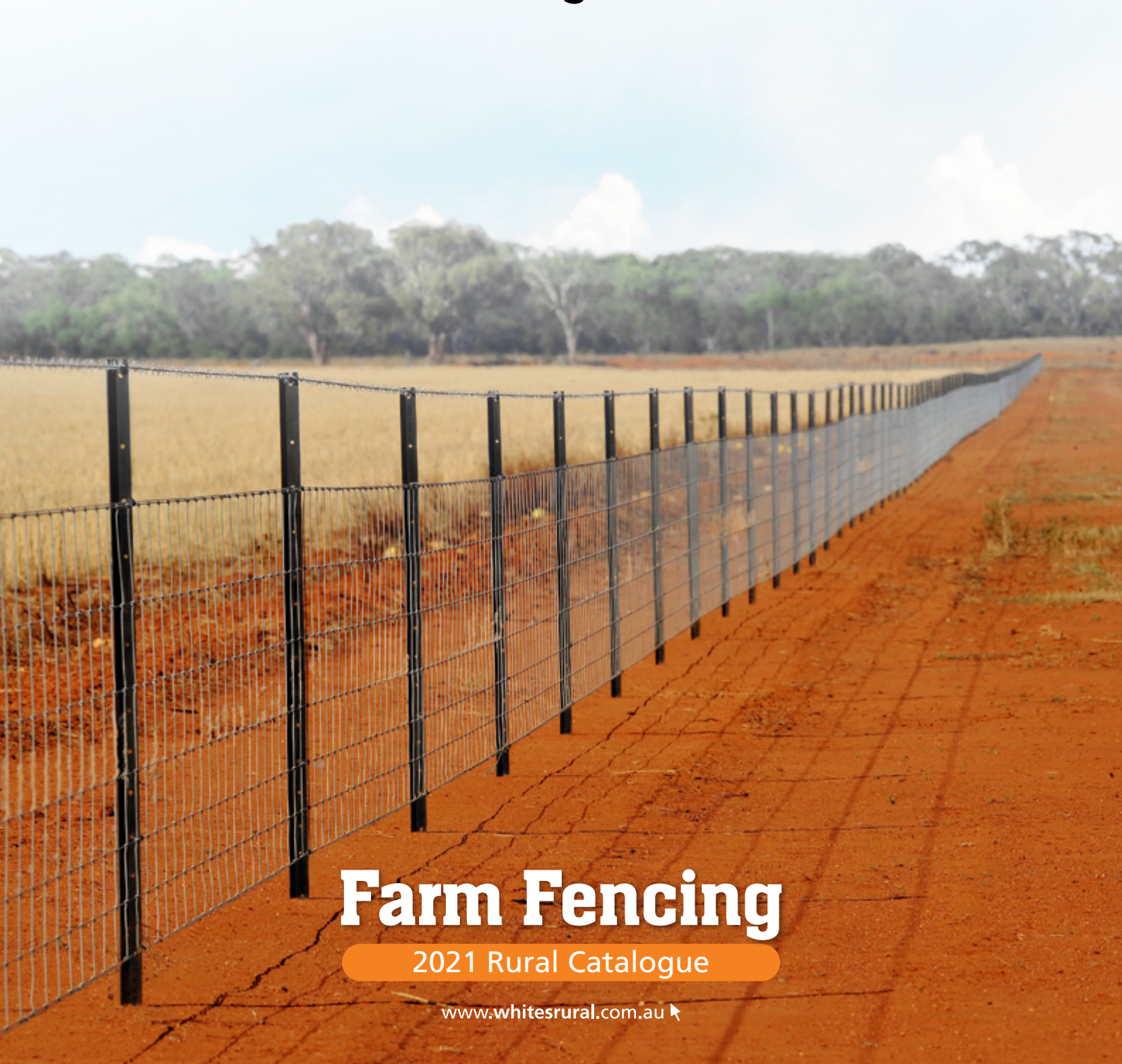

Posts • Fencing • Gates • Tools



Farm Fencing

2021 Rural Catalogue

www.whitesrural.com.au ➤



Posts • Fencing • Gates • Tools

Australian family owned, down to earth, no nonsense

Whites Group has been listening and responding to the needs of Australian farmers and fencing contractors for over 40 years. Continuously developing better fencing ideas proven to work on the farm, Whites Group has pioneered a number of original ideas like Stockpost Ute Pack, designed to get the job done with a minimum of fuss.

Australian owned and operated, Whites Group is a family business with its roots strongly embedded in steel, wire and fencing products since 1977. Today, Australian manufacturing is at the heart of Whites Rural's wire range made in Albury NSW, signifying a deeper, long-term commitment to the needs of rural Australia.



Australian Family Owned

FARM FENCING

Rural Catalogue



STOCKPOST

the mark of a good post

Stockpost®	4
Farm Posts	4
Stockpost® Ute Pack®	5
Droppers	5
Stockpost® XL	6
Stockpost® End Assembly	7
Stockpost® Anti-Sink Plate	7

FENCING

Fence Wire	8
Barbed Wire	9
Horse Sight Fence Wire	9
Stiff Stay® Prefabricated Fencing	10-11
Hinged Joint	13
Heavy Netting	14
Farm Mesh	15
Horticulture	24

GATES & FITTINGS

Gate Fittings	16-17
Farm Gates	18-19
Blue Label Farm Gates	20
XHD & Horse Mesh Farm Gates	21
Specialty Farm Gates	22
Welded Mesh	23

TOOLS

Accessories	25
Farm Pak™ Tie Wires	25
Drivers, Lifters & Wire Spinners	26
Strainers	27
Stapling	28-29
Fastening	30
MaxTensor®	31

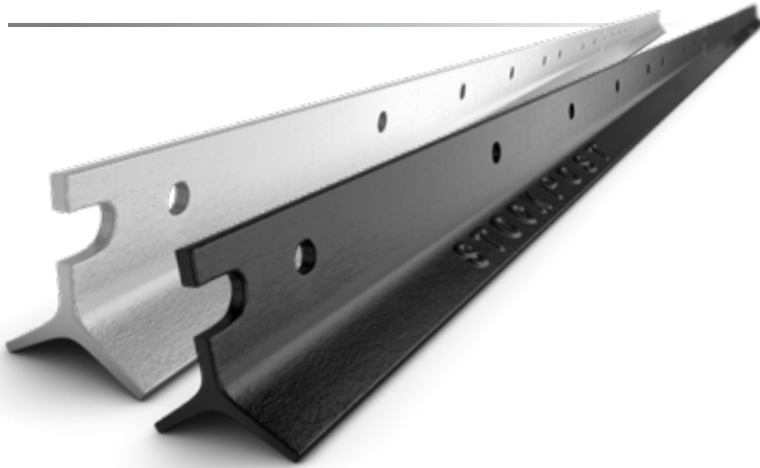

Code	Product	Size (ft)	Sling Qty	Weight (each)	Coating
STOCKPOST® - BLACK BITUMINOUS					
10804	135cm STOCKPOST	4'6"	400	2.6kg	Black
10807	150cm STOCKPOST	5'	400	2.8kg	Black
10805	165cm STOCKPOST	5'6"	400	3.1kg	Black
10806	180cm STOCKPOST	6'	400	3.4kg	Black
10809	210cm STOCKPOST	7'	200	4.0kg	Black
10808	240cm STOCKPOST	8'	200	4.6kg	Black
STOCKPOST® - HOT-DIPPED GALVANISED					
10814	135cm STOCKPOST	4'6"	200	2.6kg	Galvanised
10817	150cm STOCKPOST	5'	200	2.8kg	Galvanised
10815	165cm STOCKPOST	5'6"	200	3.1kg	Galvanised
10816	180cm STOCKPOST	6'	200	3.4kg	Galvanised
10819	210cm STOCKPOST	7'	200	4.0kg	Galvanised
10818	240cm STOCKPOST	8'	200	4.6kg	Galvanised

Code	Product	Size (ft)	Sling Qty	Weight (each)	Coating
FARM POST - BLACK BITUMINOUS					
10885	165cm Farm Post	5'6"	400	2.8kg	Black
10886	180cm Farm Post	6'	400	3.1kg	Black
FARM POST - HOT-DIPPED GALVANISED					
10889	165cm Farm Post	5'6"	400	2.8kg	HDG
10888	180cm Farm Post	6'	400	3.1kg	HDG

STOCKPOST[®]

the mark of a good post

STOCKPOST[®]

Trusted, tried & true.

Consistently rolled from specially produced high grade steel, Stockpost is a premium fence post – strong and reliable.

- ✓ High strength, high consistency
- ✓ Coatings that withstand the test of time
- ✓ Innovative ground mark
- ✓ Hole alignment that's straight up
- ✓ Easy to drive

Stockpost is available in black bituminous dipped coating, providing a tough outer barrier, or hot-dipped galvanised to meet the Australian Standards for optimum protection.

Featuring consistent ground marks and centre marks for accurate height positioning; precision hole alignment & spacing for a uniform fence from the first to the last post; and uniformly cut end-points to drive in straight and easy.

Hole Spacing

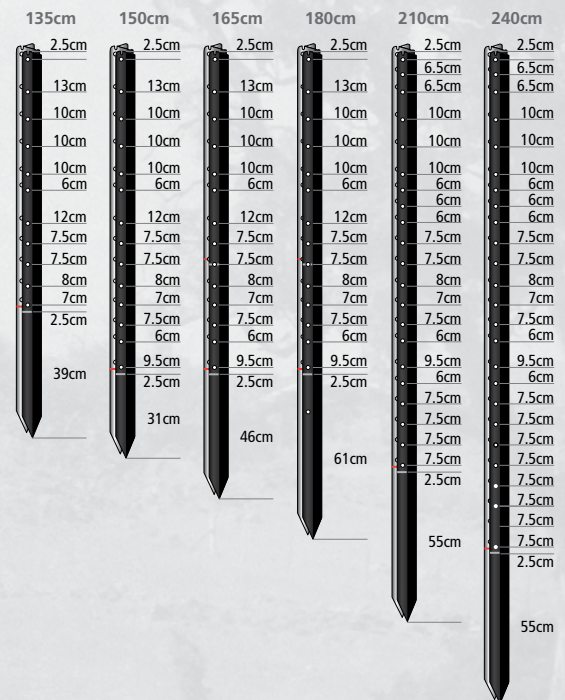

FARM POST

Farm Posts are a mid-weight economical post for multi applications. Available in black and galv coatings. Standard pre-punched holes and pointed ends.

STOCKPOST® UTE PACK®

Australian designed Ute Pack - Stockpost quality & features in a contractor pack.

200 Stockposts in a secure steel cradle... and no tie wires!



▼ **Effortless Handling**
Packed as singles.
No bundle ties.



▼ **Easy Load Pack**
Front-end loader
and ute friendly.



▼ **Fast & Efficient**
Get it onto the ute
and into the ground.



▼ **Refastenable Pack**
Use some or all,
posts stay secure.



▼ **Australian Design**
Designed & patented in
Australia, for Australian
farmers.



Stronger, Longer, Further
*...just got **FASTER!***

Code	Product	Size (ft)	Sling Qty	Weight (each)	Coating
STOCKPOST® - BLACK BITUMINOUS					
10801	165cm STOCKPOST - UTE PACK	5'6"	200	3.1kg	Black
10802	180cm STOCKPOST - UTE PACK	6'	200	3.4kg	Black
10803	225cm STOCKPOST - UTE PACK	7'6"	200	4.3kg	Black
STOCKPOST® - HOT DIPPED GALVANISED					
10811	165cm STOCKPOST - UTE PACK	5'6"	200	3.1kg	Galv
10812	180cm STOCKPOST - UTE PACK	6'	200	3.4kg	Galv
10810	225cm STOCKPOST - UTE PACK	7'6"	200	4.3kg	Galv

DROPPERS

Whites Rural Fence Droppers are manufactured from high grade steel and heavily galvanised to ensure long life. Use with barbed wire or plain wire.

- Manufactured from high tensile steel
- Heavily galvanised for long life
- Pack of 25 includes tool and clips

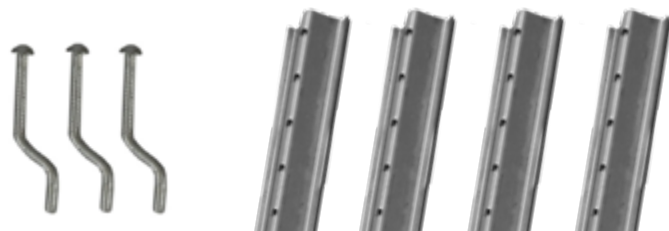

Code	Product	Sling Qty	Weight (each)	Coating
STEEL FENCE DROPPERS				
10510	63.5cm Droppers	25	6kg	Hot Dip Galvanised
10511	81.5cm Droppers	25	9.4kg	Hot Dip Galvanised
10512	94cm Droppers	25	10.6kg	Hot Dip Galvanised
10514	107cm Droppers	25	12.2kg	Hot Dip Galvanised
10515	117cm Droppers	25	13.3kg	Hot Dip Galvanised
10516	Dropper Clips 500gm	-	-	-

STOCKPOST® END ASSEMBLY

An end assembly system featuring two post types and a fully hot-dipped galvanised Stay Assembly Kit. Made to Stockpost's strict specifications.

Square Anchor Post: Fully hot-dipped galvanised with shark-tooth design end, to cut through soil for effortless driving.

Round Strainer Post: Australian-made (Albury NSW), and galvanised for a longer life.

Both posts feature Stockpost's unique ground mark, pre-drilled holes and heavy duty wall thicknesses.

The Stay Assembly Kit includes a 3m brace pipe with specially designed brace cap for ease of installation; a heavy duty fire-proof base plate; and a notched threaded rod for easy tensioning.

The Stockpost End Assembly range also includes gate fittings and additional brace caps for 2, 3, and 4-way configurations.



fireproof
base plate



innovative
ground mark



pre-drilled holes &
multiple configurations



heavy duty
brace cap



clever edges to
avoid compaction



**STAY
ASSEMBLY**
Suitable for timber posts

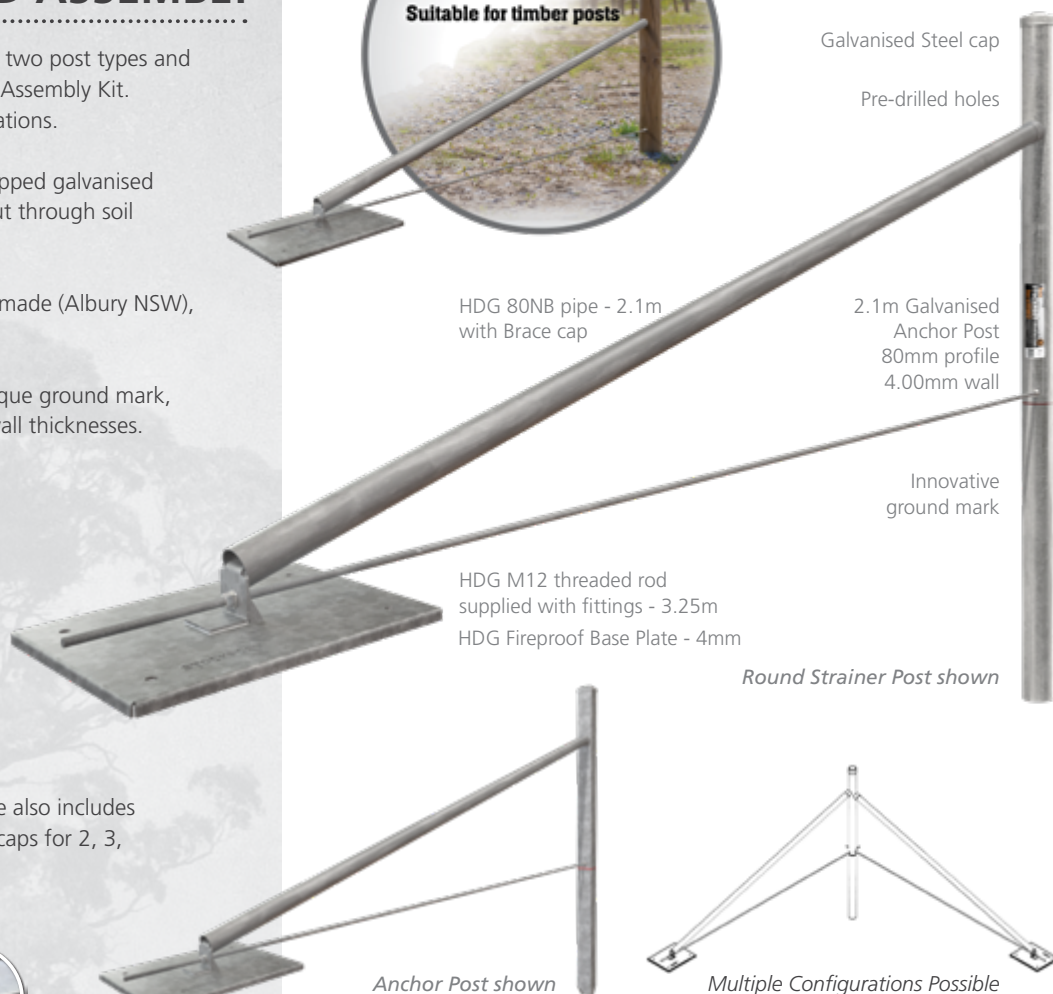

HDG 80NB pipe - 2.1m
with Brace cap

2.1m Galvanised
Anchor Post
80mm profile
4.00mm wall

Innovative
ground mark

HDG M12 threaded rod
supplied with fittings - 3.25m
HDG Fireproof Base Plate - 4mm

Round Strainer Post shown

Anchor Post shown

Multiple Configurations Possible

STOCKPOST® ANTI-SINK PLATE

Stabilise steel fence posts in soft or loose soils. The surface area of the wide base guards against sinking and limits movement. Simply attach at ground level using the steel locking pin. Easily retro-fitted to existing fences.

- High strength, galvanised steel
- Large 15cm base, greater support
- Suits Stockpost and Stockpost XL and most other steel "Y" posts

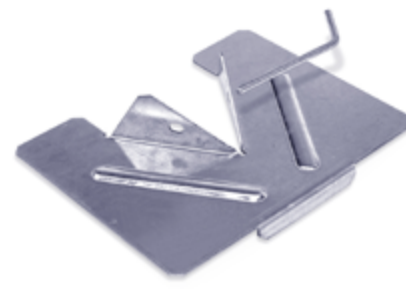

Code	Product	Pack Qty	Weight (each)
STOCKPOST® - ANTI-SINK PLATE			
12218	STOCKPOST Anti-Sink Plate	20	0.2kg

Code	Product	Pack Qty	Weight (each)
STOCKPOST® - END ASSEMBLY SYSTEM			
10880	STOCKPOST Round Strainer Post 2.1m	5	11kg
10870	STOCKPOST Anchor Post 2.1m	5	22.5kg
10875	STOCKPOST Stay Assembly 3m	5	17.1kg
STOCKPOST® - END ASSEMBLY ACCESSORIES			
10876	STOCKPOST Brace Cap with Spike	10	0.5kg
13855	End Assembly Gate Fitting Top Strap & Gudgeon	5	2.4kg
13856	End Assembly Gate Fitting Drop Latch & Eyelet	5	1kg



Meets
Australian
Standards

Code	Wire	Tensile Strength	Coil Length	Coil Weight	Sling Qty	Galv. Coating	Rec. Tension Breaking Strain
HEAVILY GALVANISED FENCE WIRE							
10014	2.50mm	Medium	1500m	58kg	10	Heavy	1.3kn, 3.7kn
10015	2.50mm	High	1500m	58kg	10	Heavy	1.8kn, 5.4kn
10016	2.80mm	High	1000m	48kg	10	Heavy	2.0kn, 6.8kn
10017	3.15mm	Soft	750m	46kg	10	Heavy	1.2kn, 3.0kn
10018	4.00mm	Soft	500m	50kg	10	Heavy	1.8kn, 4.8kn
STANDARD GALVANISED FENCE WIRE							
10161	4.00mm	Soft	500m	49kg	10	Standard	1.8kn, 4.8kn
10163	3.15mm	Soft	750m	46kg	10	Standard	1.2kn, 3.0kn
10170	2.50mm	Medium	1500m	58kg	10	Standard	1.3kn, 3.7kn
10171	2.50mm	High	1500m	58kg	10	Standard	1.8kn, 5.4kn
STANDARD GALVANISED TIE WIRE							
10164	2.50mm	Soft	1300m	50kg	10	Standard	1.3kn, 3.7kn
10165	2.00mm	Soft	2000m	50kg	10	Standard	-
10166	1.57mm	Soft	3200m	50kg	10	Standard	-



Code	Wire	Tensile Strength	Coil Length	Coil Weight	Sling Qty	Galv. Coating	Rec. Tension Breaking Strain
HANDYFENCE™							
10011	2.50mm	Medium	300m	11.6kg	10	Standard	1.3kn, 3.7kn
10012	3.00mm	Soft	250m	13.9kg	10	Standard	1.2kn, 3.0kn

RURAL FENCE WIRE

Whites Rural Heavily Galvanised and Standard Galvanised Rural Fence Wire are made to the highest standards, exclusively from Whites Albury Manufacturing plant in regional Australia, using premium grade wire.

Heavily Galvanised

Heavily Galvanised to last up to four times longer than standard galvanising.

Standard Galvanised

Standard Galvanised Fence Wire and Tie Wire are economical fencing options, with a quality you can trust.

- Soft - easy to handle and tie
- Medium Tensile - ideal with prefab fencing
- High Tensile - suited to longer strains

The wire is recoiled on new machines to provide smooth & tangle free delivery off the wire spinner, saving contractors and farmers expensive down time. Produced on the latest, highest tolerance recoilers to electronically deliver full and accurate details for each coil of wire.



HANDYFENCE™

Whites Rural Handyfence coils, a great option for smaller fencing runs or for quick and easy repairs to fences.

FENCE WIRE

Barbed & Specialty Wires



BARBED WIRE

Whites Rural Barbed Wire is made in Australia to the highest standards, exclusively from Whites Albury Manufacturing plant in regional Australia, using premium grade wire.

Produced on new machines which are the latest and highest tolerance barbed wire machines available today, the barbs are tightly twisted to prevent them from slipping out of position. All barbed wires are supplied rolled on hardwood timber reels.

High Tensile Barbed Wire

Reverse twist style for optimum strength & tensioning.

IOWA Barbed Wire

IOWA continuous-twist style.



Meets
Australian
Standards

Code	Wire	Tensile Strength	Coil Length	Coil Weight	Pallet Qty	Galv. Coating	Rec. Tension Breaking Strain
HIGH TENSILE BARBED WIRE							
10100	2.00mm	High	500m	37kg	36	Heavy	1.6kn, 5.0kn
10101	1.80mm	High	500m	28kg	36	Heavy	1.3kn, 4.0kn
10102	1.57mm	High	500m	24kg	48	Heavy	1.3kn, 3.0kn
IOWA BARBED WIRE							
10150	2.50mm	Soft	400m	45kg	27	Standard	1.3kn, 3.0kn
10151	2.50mm	Soft	400m	45kg	27	Heavy	1.3kn, 3.0kn

HORSE SIGHT FENCE WIRE

Used as a top wire on horse fencing to increase visibility and prevent injury to horses.

- White PVC coating improves visibility
- Reduces damage to fences and injury to horses
- UV stabilised PVC coating



*5.2mm total diameter including PVC coating

Code	Wire	Tensile Strength	Coil Length	Coil Weight	Sling Qty	Galv. Coating	Rec. Tension Breaking Strain
HORSE SIGHT FENCE WIRE							
10169	5.2mm*	Soft	400m	43kg	5	Standard	2.0kn, 6.0kn

STIFF STAY®

PREFABRICATED FARM FENCING



Heavily Galv. Code (Weight)	Product	Roll Length	Tensile Strength	Pallet Qty
STIFF STAY® HORSE FENCING				
10264 (68kg)	10/90/5	50m	High	9
10256 (93kg)	13/122/5	50m	High	9

FENCING

STIFF STAY

Prefabricated Fencing

STIFF STAY®

Stiff Stay prefabricated fencing features a tight cross-over knot manufactured on the Stiff Stay machine. The name Stiff Stay is trademarked to Whites and is made in Australia to the highest standards, exclusively from Whites Albury Manufacturing plant in regional Australia, using premium grade wire.

The Stiff Stay knot locks the wires in place to resist buckling and sagging. The shape of the knot provides a smooth surface so it is safe and easy to use.

- ✓ Heavily galvanised for longer life
- ✓ Tight cross-over knot
- ✓ Resists buckling and sagging
- ✓ Smooth, safe and easy to use
- ✓ High tensile line wires
- ✓ 2.80mm top & bottom wires
- ✓ Available in rolls up to 500m

HORSE FENCE

Whites Rural Stiff Stay Fabricated Horse Fence is specifically designed to be safer for horses. Made in Australia to the highest standards, exclusively from Whites Albury Manufacturing plant in regional Australia, using premium grade wire.

The tight 5cm picket spacings provide safety from hoof and leg tangling, minimising injuries to horses.

- Smooth clean knot prevents injury to horses
- Smaller aperture mesh
- Resists buckling and sagging

Made to the highest standards using premium grade wire.

Heavily Galvanised features high tensile 2.8mm line wires at top and bottom; 2.5mm high tensile line wires & 2.5mm vertical stay wires.

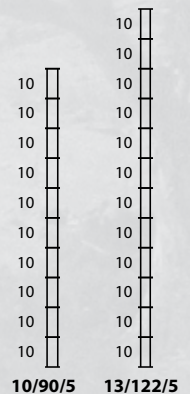

STIFF STAY

Prefabricated Fencing

FARM FENCING

Manufactured to Australian Standards AS 2423-2002 and zinc coated to AS/NZS 4534-2006. Made in Australia to the highest standards, exclusively from Whites Albury Manufacturing plant in regional Australia, using premium grade wire.

Heavily Galvanised Stiff Stay features high tensile 2.8mm line wires at top and bottom; 2.5mm high tensile line wires with graduated spacings; 2.5mm vertical stay wires.

Also available in Standard Galvanised with 2.5mm top and bottom line wires.

Spacing Chart

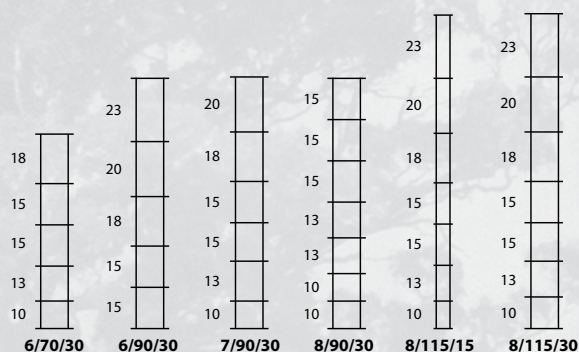

Heavily Galv. Code (Weight)	Standard Galv. Code (Weight)	Product	Roll Length	Tensile Strength	Pallet Qty
STIFF STAY® FABRICATED FARM FENCING					
10231 (72kg)	A0201 (68kg)	6/70/30	200m	High	9
A0261 (180kg)		6/70/30	500m	High	4
10232 (78kg)		6/90/30	200m	High	9
A0262 (195kg)		6/90/30	500m	High	4
10233 (86kg)	10203 (81kg)	7/90/30	200m	High	9
10263 (215kg)	10223 (202kg)	7/90/30	500m	High	4
10238 (63kg)		8/90/15	100m	High	9
A0266 (156kg)		8/90/15	250m	High	4
10234 (94kg)	A0204 (89kg)	8/90/30	200m	High	9
A0265 (235kg)		8/90/30	500m	High	4
10239 (69kg)		8/115/15	100m	High	9
A0269 (172kg)		8/115/15	250m	High	4
10261 (101kg)		8/115/30	200m	High	9

STIFF STAY[®]

Exclusion Fencing



Heavily Galv. Code (Weight)	Product	Hinged Apron	Roll Length	Tensile Strength	Pallet Qty
STIFF STAY[®] EXCLUSION FENCING					
10235 (62kg)	8/80/15		100m	High	9
10238 (63kg)	8/90/15		100m	High	9
A0266 (156kg)	8/90/15		250m	High	4
A0268 (209kg)	8/90/15	30cm 3-line	250m	High	4
10289 (76kg)	11/90/15		100m	High	9
10285 (97kg)	11/90/15	30cm 4-line	100m	High	9
10251 (86kg)	13/90/15		100m	High	9
10255 (106kg)	13/90/15	30cm 3-line	100m	High	9
10239 (69kg)	8/115/15		100m	High	9
A0269 (172kg)	8/115/15		250m	High	4
A0271 (225kg)	8/115/15	30cm 3-line	250m	High	4
10259 (92kg)	13/115/15		100m	High	9
A0273 (140kg)	13/115/15	30cm 3-line	100m	High	9
A0272 (228kg)	13/115/15		250m	High	4
A0274 (281kg)	13/115/15	30cm 3-line	250m	High	4
10260 (118kg)	15/150/15		100m	High	9
A0276 (130kg)	15/150/15	30cm 3-line	100m	High	9
A0275 (273kg)	15/150/15		250m	High	4
A0277 (325kg)	15/150/15	30cm 3-line	250m	High	4
A0278 (651kg)	15/150/15	30cm 3-line	500m	High	1

EXCLUSION FENCING

Narrow 15cm picket spacings for smaller animals and made in Australia to the highest standards, exclusively from Whites Albury Manufacturing plant in regional Australia, using premium grade wire.

Stiff Stay exclusion fencing features:

Premium Coating & Wire Grade

- Heavily Galvanised
- 2.8mm high tensile top and bottom line wires
- 2.5mm high tensile line wires and 2.5mm vertical stay wires

Continuous Vertical Pickets

- Stiff Stay features continuous vertical pickets which are locked into place to resist sagging & buckling
- Compared to hinged joint fencing, they also provide a better fence over undulating land following the contour of the ground

Optional Pre-attached Hinged Apron

- Pre-attached to the bottom line wire with a hinged joint, the apron is a 300mm section of fence laid on the ground, restricting penetration or digging under the fence
- Exclusion fencing without hinged aprons require the fencing to be forced onto the ground, placing unnecessary stress on your fence posts
- The hinged version is both faster to install and easier on the fence, giving it a longer service life
- Also referred to as a hinged footer

Pre-Stripped Roll

- Stiff Stay has the first two pickets and the last two pickets removed from every roll
- A convenient aid for faster installation around end assemblies - no need to strip picket wires

Tension Crimps

- Stiff Stay line wires include tension crimps that provide a quick visual when judging the correct tension
- When the crimp is half flattened, the tension is generally sufficient; when no crimp can be seen, then the tension in the wire is too high and needs to be reduced

Spacing Chart

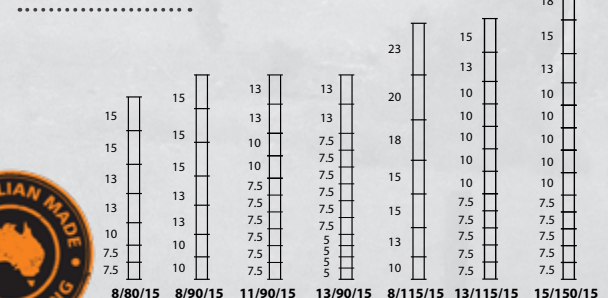

Also available as apron only for fitting to existing fences.

HINGED JOINT

Prefabricated Fencing



HINGED JOINT

Whites Rural Hinged Joint Prefabricated Farm Fencing is made in Australia to the highest standards, exclusively from Whites Albury Manufacturing plant in regional Australia, using premium grade wire.

- Ideal for stock, boundary and internal fencing
- Flexible knot absorbs stock impact
- 2.50mm high tensile line wires

The strength of the tightly wrapped knot resists livestock pressure while remaining flexible enough to retain its structure. The hinged joint "knot" allows the fence to flex under stock pressure, absorbing the impact of livestock so the fence regains its shape.

Also available in Heavily Galvanised with 2.8mm top and bottom line wires.

Spacing Chart

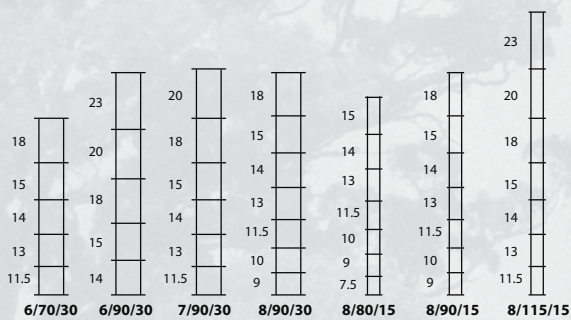

FARMLITE™ HINGED JOINT

Whites Rural Farmlite Hinged Joint is Australian made (Albury, NSW) using a lighter gauge premium wire for cost-effective fencing.

Ideal for hobby farms and smaller rural properties. 2.0mm medium tensile standard galvanised line wires with 2.5mm top and bottom wires.

WILD DOG HINGED JOINT

Tight picket spacings protect against feral animals. High tensile 2.0mm line wires and 2.0mm picket wires, 2.5mm top and bottom wires, heavily galvanised to AS4534.

FARMLITE™ HINGED JOINT

Farmlite Hinged Joint is a cost-effective solution for hobby farms and smaller rural properties. Made from 2.00mm standard galvanised wires.



Code	Product	Tensile Strength	Roll Length	Roll Weight	Pallet Qty	Galv. Coating	Line Wire
STANDARD GALVANISED HINGED JOINT							
10291	6/70/30	High	200m	70kg	9	Standard	2.5mm
10292	6/90/30	High	200m	74kg	9	Standard	2.5mm
10293	7/90/30	High	200m	83kg	9	Standard	2.5mm
10294	8/90/30	High	200m	92kg	9	Standard	2.5mm
10295	8/80/15	High	100m	60kg	9	Standard	2.5mm
10298	8/90/15	High	100m	61kg	9	Standard	2.5mm
10299	8/115/15	High	100m	69kg	9	Standard	2.5mm

Code	Product	Tensile Strength	Roll Length	Roll Weight	Pallet Qty.	Galv. Coating	Line Wire
FARMLITE™ HINGED JOINT							
10283	8/115/15	Medium	100m	48kg	9	Standard	2.0mm

Code	Product	Tensile Strength	Roll Length	Roll Weight	Pallet Qty.	Galv. Coating	Top/Base Wire
HINGED JOINT - WILD DOG							
10287	13/115/15	High	100m	56kg	9	Heavy	2.5mm

Code	Product	Tensile Strength	Roll Length	Roll Weight	Pallet Qty	Galv. Coating	Line Wire
FARMLITE™ HINGED JOINT							
10281	8/90/15	Medium	100m	42kg	9	Standard	2.0mm
10282	8/115/15	Medium	100m	46kg	9	Standard	2.0mm
10272	8/115/15	Medium	50m	24kg	16	Standard	2.0mm

HEAVY NETTING

Rural & Boundary Fence



Code	Height	Aperture nom.	Wire Dia. nom.	Roll Length	Roll Weight	Pallet Qty	Galv. Coating
HEAVY NETTING							
10451	30cm	4cm	1.4mm	50m	13kg	48	Heavy
10452	60cm	4cm	1.4mm	50m	26kg	18	Heavy
10454	90cm	4cm	1.4mm	50m	36kg	9	Heavy
10474	90cm	4cm	1.4mm	100m	75kg	9	Heavy
10455	105cm	4cm	1.4mm	50m	42kg	9	Heavy
10475	105cm	4cm	1.4mm	100m	86kg	9	Heavy
10456	120cm	4cm	1.4mm	50m	48kg	9	Heavy
10458	180cm	4cm	1.4mm	50m	74kg	9	Heavy



Code	Height	Aperture nom.	Wire Dia. nom.	Roll Length	Roll Weight	Pallet Qty	Galv. Coating
HEAVY NETTING - BOUNDARY							
10653	90cm	5cm	1.6mm	50m	37kg	9	Heavy
10655	120cm	5cm	1.6mm	50m	48kg	9	Heavy
10657	180cm	5cm	1.6mm	50m	71kg	9	Heavy

RURAL NETTING

Whites Rural Heavy Netting is a versatile heavily galvanised netting for rural and heavy duty applications.

- Reverse twist construction
- Double selvedge wires for added strength
- Heavily galvanised

Netting with a 4cm aperture, 1.4mm wire diameter (often referred to as rabbit netting) & is available in varying heights. Suggested uses are:

- 30cm** - reconditioning of existing fences, garden edging
- 60cm** - reconditioning of existing fences, poultry
- 90cm** - rabbit proofing, boundary fencing & tree guards
- 105cm** - rabbit proofing, boundary fencing & tree guards
- 120cm** - boundary and feral fencing, poultry
- 180cm** - feral fencing, poultry and animal enclosures



BOUNDARY NETTING

Whites Rural Heavy Duty Boundary Netting has a 5cm aperture, 1.6mm wire diameter & is available in varying heights. Suggested uses are:

- 90cm** - farm fencing, dogs & tree guards
- 120cm** - feral fencing, animal enclosures & tree guards
- 180cm** - feral fencing, animal enclosures & tennis courts



FARM MESH

Welded Mesh

FARM MESH HEAVY DUTY

Whites Rural Farm Mesh Heavy Duty is a 2.5mm general purpose welded mesh for heavy duty applications.

- Heavy welded construction
- Flush cut edges
- 2.5mm galvanised wire

Whites Rural Farm Mesh can be used for a variety of applications, including:

- Cages and animal enclosures
- Drainage grids
- Fencing and tree guards
- Trailer enclosures

FARM MESH HEAVY DUTY HEAVILY GALVANISED

A heavily galvanised version of the Whites Rural Farm Mesh Heavy Duty.

- Heavily galvanised to AS4534
- 75mm x 50mm aperture
- 2.5mm for heavy duty applications
- Heavy welded construction
- Flush cut edges



DOG MESH HEAVY DUTY

Whites Rural Dog Mesh Heavy Duty is an ideal fencing mesh to keep larger dogs and similar sized animals within a boundary, or out of garden beds and yards.

- Graduated mesh
- Heavy welded construction
- Flush cut edges
- 2.5mm galvanised wire

Line and picket wires have been strengthened for added rigidity. The graduated mesh is available in 120cm & 180cm heights, with smaller apertures at the base to fence puppies and smaller animals.



Code	Height (cm)	Aperture (mm)	Wire Diameter	Roll Length	Roll Weight	Pallet Qty	Galv. Coating
HEAVY DUTY FARM MESH							
21982	90	75 x 50	2.5mm	30m	34kg	9	Standard
21983	120	75 x 50	2.5mm	30m	46kg	9	Standard
21988	180	75 x 50	2.5mm	30m	69kg	9	Standard
21980	90	100 x 100	2.5mm	30m	22kg	16	Standard
21981	120	100 x 100	2.5mm	30m	29kg	16	Standard
21989	180	100 x 100	2.5mm	30m	43kg	9	Standard
HEAVY DUTY FARM MESH - HEAVILY GALVANISED							
22683	90	75 x 50	2.5mm	30m	34kg	9	Heavy
22684	120	75 x 50	2.5mm	30m	46kg	9	Heavy
HEAVY DUTY DOG MESH							
22004	120	Graduated	2.5mm	30m	23kg	16	Standard
22008	180	Graduated	2.5mm	30m	32kg	16	Standard

Ring Latch

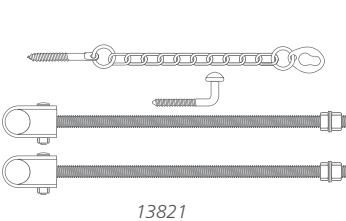
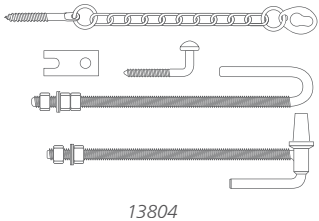
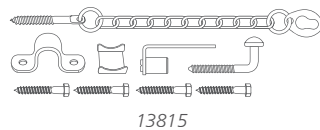
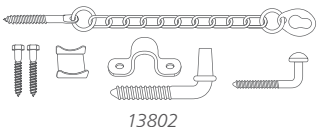
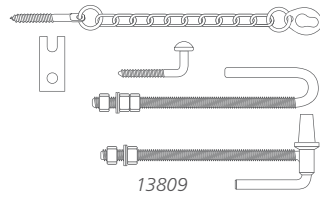
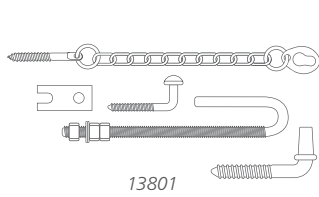

Drop Latch

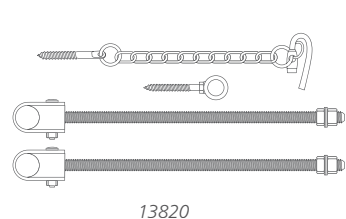
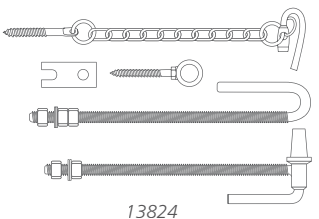
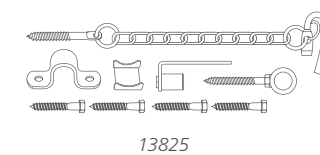
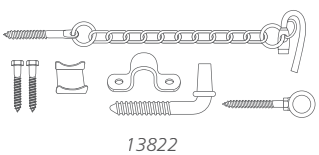

GATE FITTING SETS

A wide range of galvanised steel gate fitting sets, all the components included. Hang everything from small pedestrian gates to the largest farm gates.

Available in Drop Latch and Ring Latch:

FG1 General Purpose Pack

- Screw-in 12mm latch and catch (ring latch only)
- Top through-post strap 16mm x 300mm thread length including backing plate
- Screw-in bottom gudgeon

FG2 Economy Pack

- Screw-in 12mm latch and catch
- Top strap assembly
- Screw-in 20mm bottom gudgeon

FG4 Heavy Duty Long Pack

- Screw-in 12mm latch and catch
- Top through-post strap 16mm x 400mm thread length including backing plate
- Bottom through-post gudgeon 16mm x 400mm thread length (all nuts and washers included)

FG9 Heavy Duty Pack

- Screw-in 12mm latch and catch
- Top through-post strap 16mm x 300mm thread length including backing plate
- Bottom through-post gudgeon 16mm x 300mm thread length (all nuts and washers included)

FG15 Multi-Fit Pack

- Screw-in 12mm latch and catch
- Top strap assembly
- Screw-in / weld-on bottom gudgeon

FG20 Collared Pack (WA only)

- Screw-in 12mm latch and catch
- Top and bottom through-post hinge assemblies 20mm x 400mm thread length with U-shaped hinge (all nuts and washers included)

Ring Latch Code	Drop Latch Code	Product	Pack	Carton Qty	Weight
GATE FITTING SET - RING LATCH & DROP LATCH					
13801	-	General Purpose Pack	FG1	5	1.9kg
13802	13822	Economy Pack	FG2	10	1.6kg
13804	13824	Heavy Duty Long Pack	FG4	5	2.6kg
13809	13829	Heavy Duty Pack	FG9	5	2.5kg
13815	13825	Multi-Fit Pack	FG15	10	1.3kg
13821	13820	Collared Gates (WA only)	FG20	5	2.6kg

GATE FITTINGS

Individual & Specialty Fittings

INDIVIDUAL FITTINGS

Galvanised steel screw-in and weld-on gate fittings.

Latches

Screw-on available in drop and ring types.

Weld-on drop latch suitable for square or round posts. Can be screw-fixed. Low profile safer for animals.

Strap and Gudgeon

Top strap screw-in type.

WG34 gudgeon weld-on type.

G13 gudgeon features long plate - weld-on or screw-in.

Pins and Sleeves

Featuring pin-lock hole for added peace of mind where needed. Simply weld into place.

Each packs contains 2 pairs (2 x pins and 2 x sleeves)

Double Gate Bow

Self-locating latch for double end gates. Suits 25NB gates.

Cattle Yard Slam Latch

Tough and durable weld-on latch and striker plate for cattle yard fencing. Quick access, locks strong.

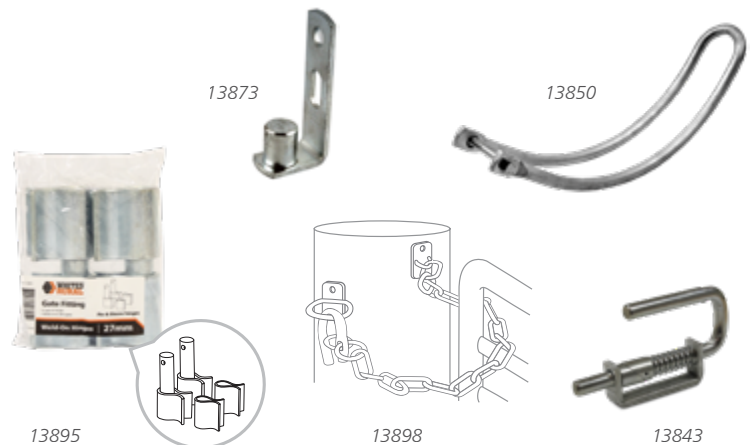

Code	Product	Type
INDIVIDUAL FITTINGS		
13830	Ring Latch & Catch	Screw
13833	Drop Latch & Eyelet	Screw
13862	Top Strap 25mm S3	Screw / Weld-on
13873	Gudgeon 25mm G13	Screw / Weld-on
13875	Gudgeon 25mm WG34	Weld-on
13895	Pins & Sleeves 27mm	Weld-on
13896	Pins & Sleeves 20mm	Weld-on
13897	Pins & Sleeves 16mm	Weld-on
13898	Drop Latch	Weld-on
DOUBLE GATE BOW		
13850	Double Gate Bow	Screw
SLAM LATCH		
13843	Slam Latch 20mm	Weld-on
13844	6mm Striker Plate 75x100mm	Weld-on

SPECIALTY GATE FITTINGS

End Assembly Gate Fittings

Designed for the Stockpost Anchor Post, the fittings attach around the anchor post with no screwing or welding required.

Top strap & gudgeon pack to hinge the gate;
drop latch pack to lock the gate.

Bolt-on Double Gate Latch

Robust fitting suitable for securing 25NB double gates.
No need for screwing or welding; just position the latch on the gate frame and tighten the bolt to attach.

Pedestrian Gate Pack

Use with pedestrian gates, the pack features an easy access "D" latch and all the components.

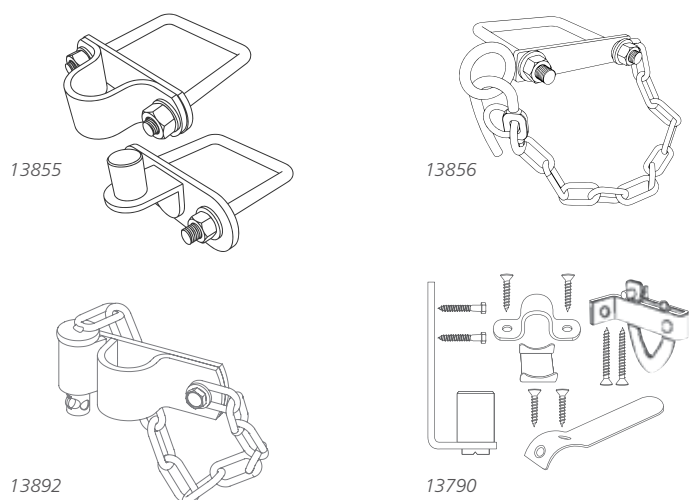

Code	Product	Carton Qty	Weight
SPECIALTY GATE FITTING SETS			
13855	End Assembly Top Strap & Gudgeon	5	1.5kg
13856	End Assembly Drop Latch & Eyelet	5	0.8kg
13892	Bolt-on Double Gate Latch	20	0.7kg
13790	"D" Latch Gate Pack	20	0.7kg



Nominal Size is the recommended gate opening

Code	Nominal mm (ft)	Actual (mm)	Stay Type	Weight	Weld Mesh (Nom. mm)
TOP NOTCH™ FARM GATES					
13122	875 (2'8")	825	-	8kg	200x100x5
13123	1075 (3'3")	1025	-	9kg	200x100x5
13124	1220 (4'0")	1170	-	10kg	200x100x5
13105	1525 (5'0")	1475	-	13kg	200x100x5
13106	1830 (6'0")	1780	-	14kg	200x100x5
13108	2440 (8'0")	2390	"I"	20kg	200x100x5
13110	3050 (10'0")	3000	"I"	22kg	200x100x5
13112	3660 (12'0")	3610	"I"	26kg	200x100x5
13132	3660 (12'0")	3610	"II"	29kg	200x100x5
13114	4270 (14'0")	4220	"II"	31kg	200x100x5
13116	4880 (16'0")	4830	"II"	36kg	200x100x5

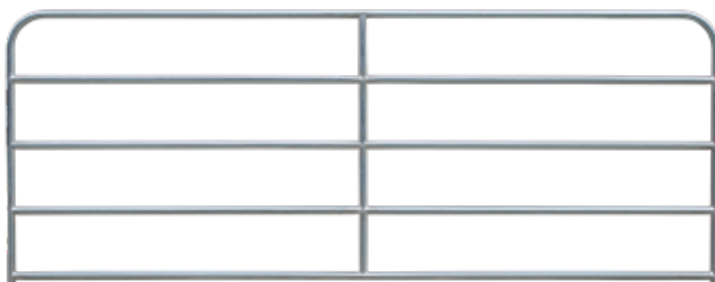

Nominal Size is the recommended gate opening

Code	Nominal mm (ft)	Actual (mm)	Stay Type	Weight	Pipe Mesh (Nom. mm)
5 BAR FARM GATES					
13204	1220 (4'0")	1170	-	13kg	25NB
13205	1525 (5'0")	1475	-	16kg	25NB
13206	1830 (6'0")	1780	-	18kg	25NB
13208	2440 (8'0")	2390	"I"	25kg	25NB
13210	3050 (10'0")	3000	"I"	29kg	25NB
13212	3660 (12'0")	3610	"I"	34kg	25NB
13214	4270 (14'0")	4220	"II"	41kg	25NB
13216	4880 (16'0")	4830	"II"	46kg	25NB

GATES & FITTINGS

FARM GATES

Top Notch & Bar Gates

TOP NOTCH™ "I" STAY GATES

Whites Rural Top Notch Gates are manufactured with embedded mesh that sits inside of the gate. Along with end welds that are smooth and flush with the pipe, it makes for a stronger, safer and faster hanging gate.

Inbuilt Strength

Embedded wire mesh increases strength, improves durability.



Edge Protect

Safer for hands and livestock.
No sharp edges!

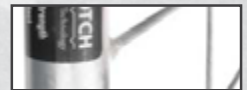

Fast Fit

No need to cut wire mesh.
Hinges fit fast!



- All pipe is a uniform 25NB
- 1145mm high, 2400-4800mm wide
- 5mm galvanised wire
- 200mm horizontal x 100mm vertical aperture
- Zinc-based coating completely covers pipe & welds
- Supplied with our "Shut the gate mate!" sign

Whites Rural Farm Gates are made to exacting standards from some of the best materials available, quality tested to ensure trouble-free fencing that is designed to last.

5 BAR FARM GATES

Whites Rural 5 Bar Farm Gates are made stronger for cattle and high pressure livestock situations, featuring horizontal hot-dipped galvanised pipe welded to the outer frame.

- All pipe is a uniform 25NB
- 1145mm high, 1000-4800mm wide
- Zinc-based coating completely covers pipe & welds



FARM GATES

"N" Stay & Collared

"N" STAY FARM GATES

Whites Rural "N" Stay Farm Gates feature 200mm x 75mm mesh size for increased strength and protection. With a diagonal brace running from bottom to top corner, the range is available in left and right hand options (pack of 5 - 3L/2R).

- All pipe is a uniform 25NB
- 1145mm high, 3000-4800mm wide
- 5mm galvanised wire
- 200mm horizontal x 75mm vertical aperture
- Zinc-based coating completely covers pipe & welds
- Supplied with our "Shut the gate mate!" sign

Consistently high quality gates manufactured from high quality galvanised pipe. The pipe is galvanised on the inside as well as the outside to provide maximum protection and a long working life.

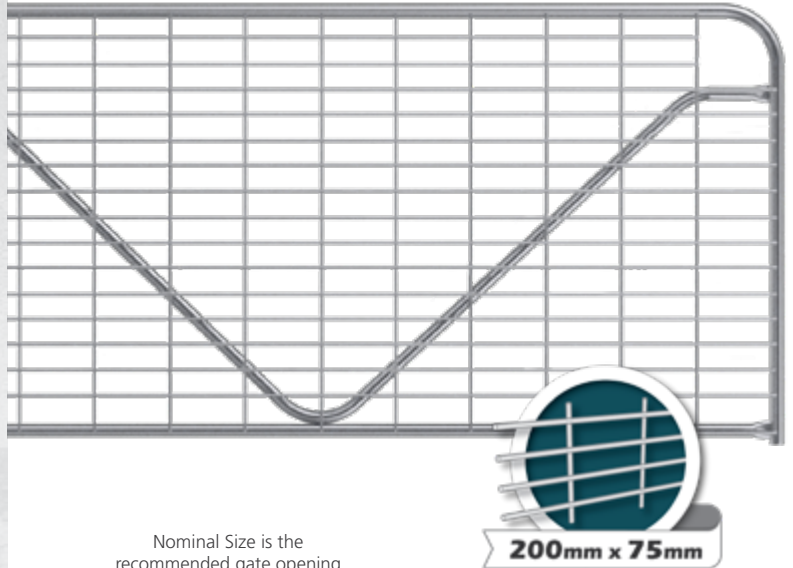
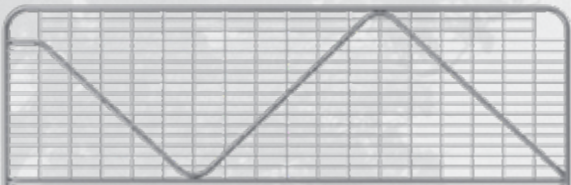

Nominal Size is the recommended gate opening

Code	Nominal mm (ft)	Actual (mm)	Stay Type	Weight	Weld Mesh (Nom. mm)
"N" STAY FARM GATES					
13510	3050 (10'0")	3000	"N"	27kg	200x75x5
13512	3660 (12'0")	3610	"N"	30kg	200x75x5
13514	4270 (14'0")	4220	"N"	34kg	200x75x5
13516	4880 (16'0")	4830	"N"	38kg	200x75x5

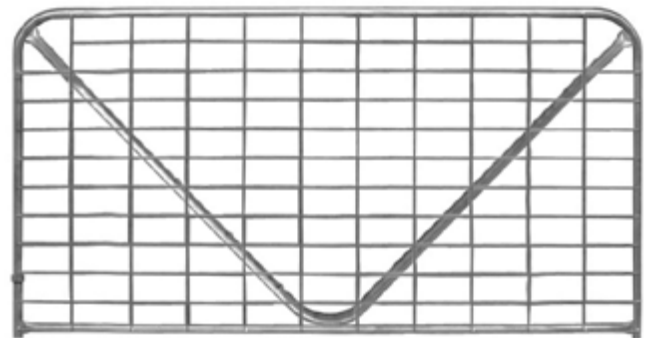

COLLARED FARM GATES

Whites Rural Collared Farm Gates recognise the specific needs of the WA rural market. A range of regular, "I" stay & "V" stay gates has been developed with a pre-fitted collar as distinctly used in Western Australia farming communities.

- All pipe is a uniform 25NB
- 1145mm high, 2400-4800mm wide
- 5mm galvanised wire
- 200mm horizontal x 100mm vertical aperture
- Zinc-based coating completely covers pipe & welds
- Supplied with our "Shut the gate mate!" sign

Code	Nominal mm (ft)	Actual (mm)	Stay Type	Weight	Weld Mesh (Nom. mm)
COLLARED "I" STAY FARM GATES (WA ONLY)					
13403	1075 (3'3")	1025	-	9kg	200x100x5
13404	1220 (4'0")	1170	-	10kg	200x100x5
13405	1525 (5'0")	1475	-	13kg	200x100x5
13406	1830 (6'0")	1780	-	14kg	200x100x5
13408	2440 (8'0")	2390	"I"	20kg	200x100x5
13410	3050 (10'0")	3000	"I"	22kg	200x100x5
13412	3660 (12'0")	3610	"I"	26kg	200x100x5
13414	4270 (14'0")	4220	"I"	31kg	200x100x5
13416	4880 (16'0")	4830	"I"	36kg	200x100x5
COLLARED "V" STAY FARM GATES (WA ONLY)					
13710	3050 (10'0")	3000	"V"	22kg	200x100x5
13712	3660 (12'0")	3610	"V"	26kg	200x100x5
13714	4270 (14'0")	4220	"V"	31kg	200x100x5
13716	4880 (16'0")	4830	"V"	36kg	200x100x5

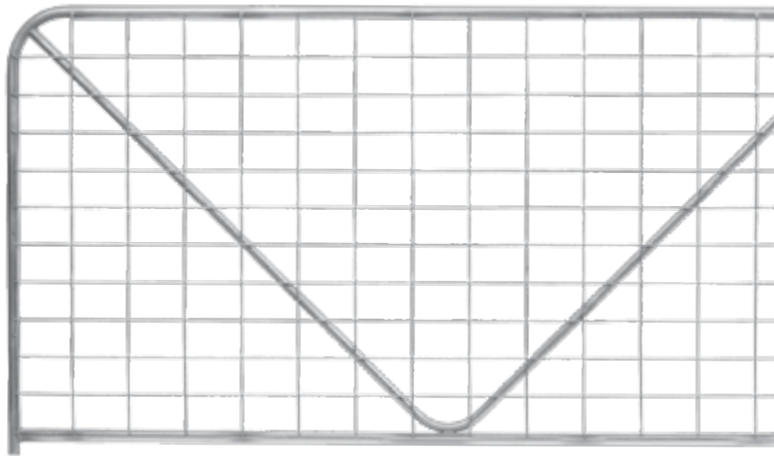

BLUE LABEL FARM GATES

Whites Rural Blue Label Farm Gates have been manufactured by Whites' Albury Manufacturing in regional Australia. Years of experience and commitment to the gate industry re-assures farmers and contractors that Whites' Albury Manufacturing gates are the right choice for a high quality gate.

All Blue Label Farm Gates feature:

- 5mm pre-galvanised wire mesh
- 150mm horizontal x 100mm vertical aperture
- 350 grade high tensile 25NB pipe
- Fully welded joints to resist joint cracking
- 1170mm high

Pipe is hot-dipped galvanised to Australian Standards. Available in "I", "II", "III" and "IIII" stays, as well as in "V", "N" and "M" stays, depending on gate length.

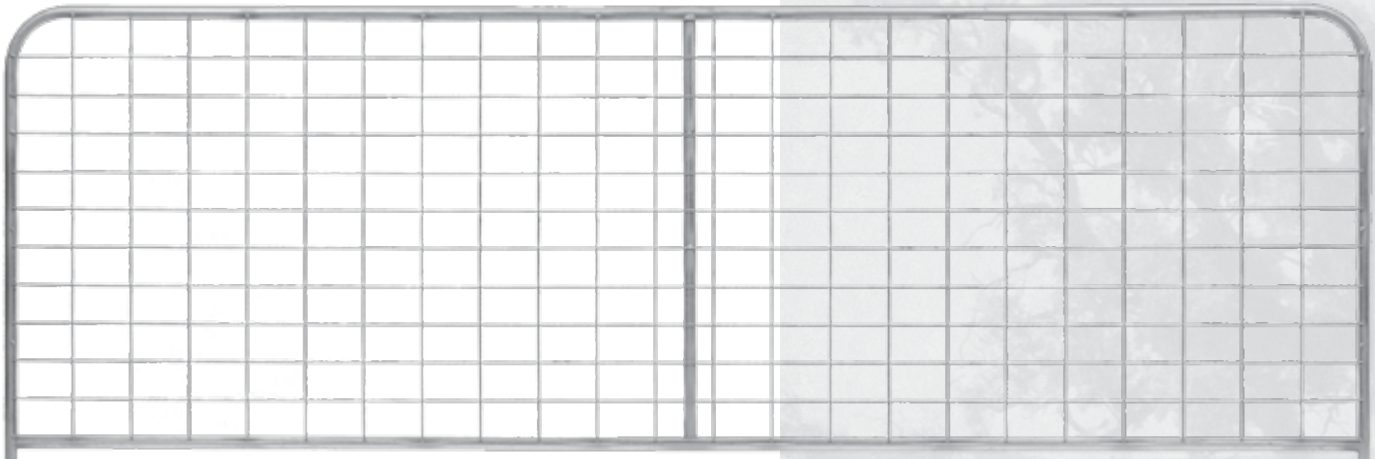

Nominal Size is the recommended gate opening

Upright Code	Stay Type	Weight (kg)	N Stay Code	Stay Type	Weight (kg)	Nominal mm (ft)	Actual (mm)	Mesh (mm)
BLUE LABEL FARM GATES								
AMS03	-	9	-	-	-	915 (3'0")	865	150x100x5
AMS04	-	11	-	-	-	1220 (4'0")	1170	150x100x5
AMS05	"I"	14	-	-	-	1525 (5'0")	1475	150x100x5
AMS06	"I"	16	-	-	-	1830 (6'0")	1780	150x100x5
AMS07	"I"	18	-	-	-	2135 (7'0")	2085	150x100x5
AMS08	"I"	19	AVG08	"V"	22	2440 (8'0")	2390	150x100x5
AMS09	"I"	21	AVG09	"V"	24	2745 (9'0")	2695	150x100x5
AMS10	"I"	23	ANS10	"N"	27	3050 (10'0")	3000	150x100x5
AMS11	"I"	25	ANS11	"N"	29	3350 (11'0")	3300	150x100x5
AMS12	"I"	27	ANS12	"N"	31	3660 (12'0")	3610	150x100x5
AMSD2	"II"	29	-	-	-	3660 (12'0")	3610	150x100x5
AMS13	"II"	31	ANS13	"N"	33	3960 (13'0")	3910	150x100x5
AMS14	"II"	32	ANS14	"N"	36	4270 (14'0")	4220	150x100x5
AMS15	"III"	36	ANS15	"N"	38	4570 (15'0")	4520	150x100x5
AMS16	"III"	38	ANS16	"N"	40	4880 (16'0")	4830	150x100x5



FARM GATES

XHD & Horse Mesh

XHD FARM GATES

Whites Rural Orange Label XHD Farm Gates feature outer frames made with 32NB x 2.6mm high tensile pipe for an extra heavy duty gate. Made in Whites' Albury Manufacturing plant in regional Australia.



ORANGE
LABEL
GATE



frauenfelder
Your Regional Manufacturer

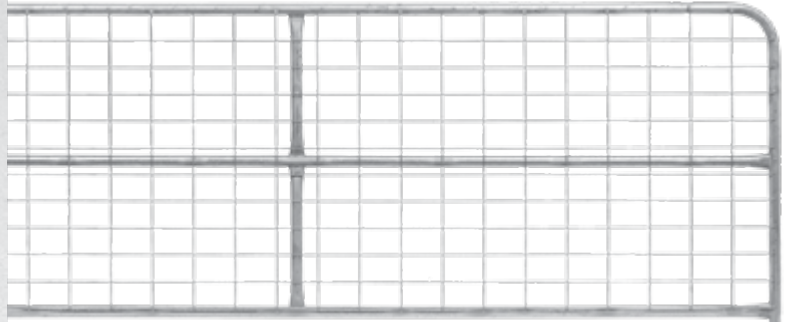

Upright gates available with a crossbar for extra strength
Nominal Size is the recommended gate opening

Code	Nominal mm (ft)	Actual (mm)	Weight	Stay Type	Frame Pipe	Stay Type	Mesh (mm)
XHD N-STAY FARM GATES							
AXN10	3050 (10'0")	3000	33kg	"N"	32NB	25NB	150x100x5
AXN12	3660 (12'0")	3610	40kg	"N"	32NB	25NB	150x100x5
AXN14	4270 (14'0")	4220	47kg	"N"	32NB	25NB	150x100x5
AXN16	4880 (16'0")	4830	53kg	"N"	32NB	25NB	150x100x5
XHD UPRIGHT FARM GATES - CROSSBAR							
AXB08	2440 (8'0")	2390	30kg	"I"	32NB	32NB	150x100x5
AXB10	3050 (10'0")	3000	36kg	"I"	32NB	32NB	150x100x5
AXB12	3660 (12'0")	3610	42kg	"I"	32NB	32NB	150x100x5
AXB14	4270 (14'0")	4220	50kg	"II"	32NB	32NB	150x100x5
AXB16	4880 (16'0")	4830	59kg	"III"	32NB	32NB	150x100x5

HORSE MESH FARM GATES

Whites Rural White Label Horse Mesh Farm Gates feature a smaller aperture mesh specifically designed to be safer for horses.

- 25NB high tensile pipe frame and braces
- 50mm horizontal x 100mm vertical aperture
- 5mm pre-galvanised wire welded mesh
- Hot-dipped galvanised pipe, fully welded joints



WHITE
LABEL
GATE



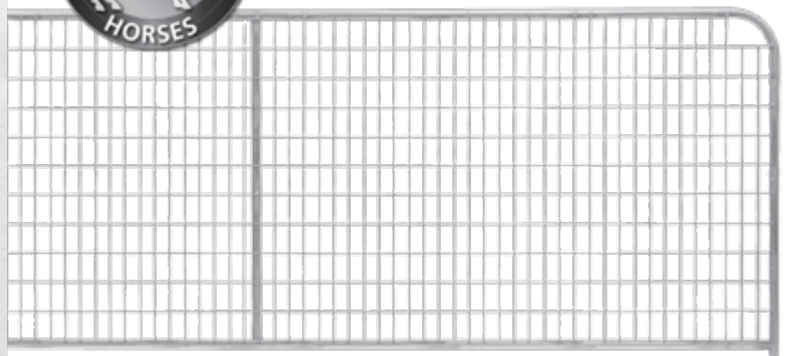

frauenfelder
Your Regional Manufacturer

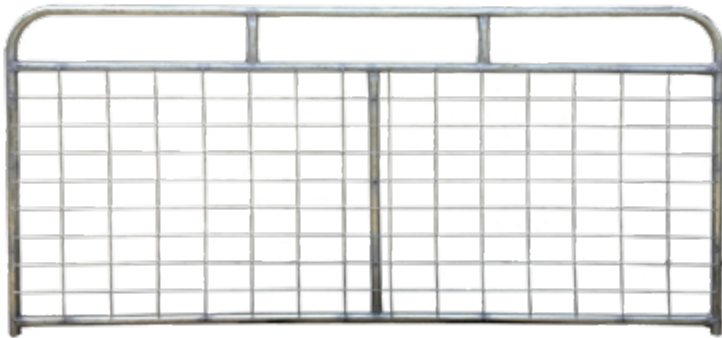

Nominal Size is the recommended gate opening

Code	Nominal mm (ft)	Actual (mm)	Weight	Stay Type	Height (mm)	Mesh (mm)
HORSE MESH FARM GATES - UPRIGHT						
AHI03	915 (3'0")	865	5kg	-	1170	100x50x5
AHI04	1220 (4'0")	1170	6kg	-	1170	100x50x5
AHI06	1830 (6'0")	1780	9kg	"I"	1170	100x50x5
AHI08	2440 (8'0")	2390	12kg	"I"	1170	100x50x5
AHI10	3050 (10'0")	3000	15kg	"I"	1170	100x50x5
AHI12	3660 (12'0")	3610	18kg	"I"	1170	100x50x5
AHI14	4270 (14'0")	4220	22kg	"II"	1170	100x50x5
AHI16	4880 (16'0")	4830	25kg	"III"	1170	100x50x5



Code	Nominal mm (ft)	Actual (mm)	Stay Type	Weight	Height (mm)	Mesh (mm)
BALLIMORE FARM GATES						
ABA10	3050 (10')	3000	"I"	27kg	1170	150x100x5
ABA12	3660 (12')	3610	"II"	31kg	1170	150x100x5
ABA14	4270 (14')	4220	"II"	36kg	1170	150x100x5
ABA16	4880 (16')	4830	"III"	40kg	1170	150x100x5

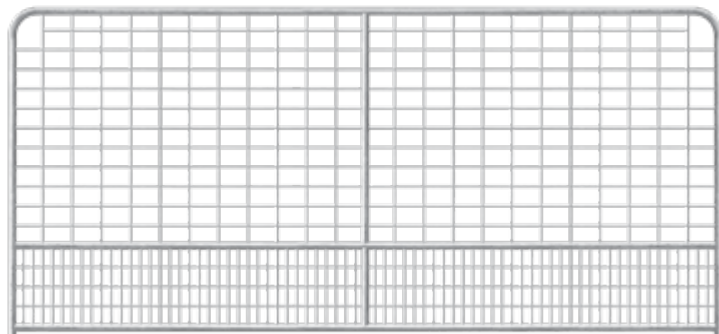

Code	Nominal mm (ft)	Actual (mm)	Stay Type	Weight	Mesh (mm)
FERAL "I" STAY FARM GATES					
13012	3660 (12')	3610	"I"	52kg	150x100x5
13014	4270 (14')	4220	"II"	62kg	150x100x5

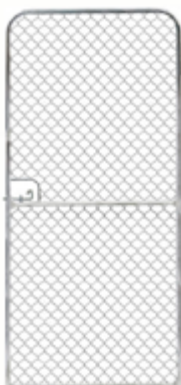

Code	Actual Length x Height (mm)	Weight
CHAIN MESH GATE		
13100	900 x 1800 (3' x 6')	13.5kg

GATES & FITTINGS

FARM GATES

Specialty Gates

BALLIMORE FARM GATES

Whites Rural Ballimore Farm Gates are significantly stronger 'I' stay gates due to their full-length bar and double 'I' stay top. The robust design is also one of the most visually appealing gates available. Made in Albury, Australia.

Ballimore Farm Gates feature:

- Full-length 25NB top bar, double 'I' stay top
- 25NB high tensile pipe frame and brace
- 150mm horizontal x 100mm vertical aperture
- 5mm pre-galvanised wire mesh
- Hot-dipped galvanised pipe to Australian Standards



FERAL "I" STAY FARM GATES

Whites Rural Feral Farm Gates are designed to keep stock safe and prevent predators boasting an increased overall height of 1660mm and tighter mesh spacings along the base. Made in Albury, Australia.

Feral Farm Gates feature:

- 1660mm overall height
- 50mm horizontal x 100mm vertical aperture along base
- 25NB high tensile pipe frame and brace
- 150mm horizontal x 100mm vertical aperture top
- 5mm pre-galvanised wire mesh
- Hot-dipped galvanised pipe to Australian Standards

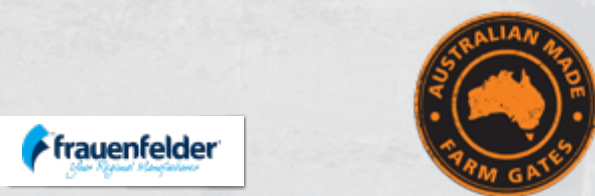

CHAIN MESH GATE

Whites Chain Mesh Pedestrian Gate is a popular gate to suit chain wire mesh fences.

WELDED MESH

Sheep Yard, General & Tree Guards

SHEEP YARD MESH

Whites Rural Sheep Yard Mesh products are manufactured flush with the outside edge of the perimeter wires. Made in Australia to the highest standards, exclusively from Whites Albury Manufacturing plant in regional Australia, using premium grade wire.

Light: 900mm high - the top two vertical apertures are set at 150mm and the lower six at 100mm. Horizontal 250mm apertures. 5mm line wires, 4mm cross wires.

Medium: 5mm wire with vertical apertures at 100mm and horizontal apertures set at 250mm. Also produced in a 5.6mm wire for special orders.

Heavy: 5mm wire with vertical apertures at 100mm and horizontal apertures set at 200mm.

Extra Heavy: 5mm wire with vertical apertures at 100mm and horizontal apertures set at 150mm.

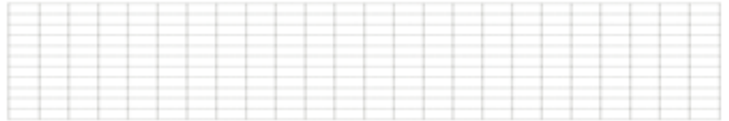

6m Length

Code	Aperture (mm)	Width (mm)	Length (m)	Weight	Wire Dia. (mm)	Type
SHEEP YARD MESH						
ASYM1	100 x 250	900	6	12.7kg	5	Medium
ASYM2	100 x 250	1100	6	15.3kg	5	Medium
ASYM3	100 x 200	900	6	13.5kg	5	Heavy
ASYM4	100 x 200	1100	6	16.3kg	5	Heavy
ASYM5	100 x 150	900	6	14.9kg	5	X Heavy
ASYM6	100 x 150	1100	6	18kg	5	X Heavy

GENERAL PURPOSE

Whites Rural General Purpose Welded Mesh panels are manufactured in a range of sizes from wire and are produced to Australian Standards. The mesh is finished flush all around for safety and to make joining easy.

Ideal for Animal Enclosures, Cages, Trailer Enclosures, Fencing, Tree Guards, Window Guards, Safety Screens, Drainage Grids, Shelves, Racks & Partitions.

- Flush cut edges on all sides
- Medium tensile galvanised wire



Code	Aperture (mm)	Width (mm)	Length (mm)	Weight	Nom. Wire Dia.
GENERAL PURPOSE MESH PANELS					
21898	25 x 25	1200	2400	7.3kg	2.25mm
21888	25 x 25	1200	2400	7.9kg	2.5mm
21880	50 x 50	1200	2400	5.7kg	3.15mm
21897	75 x 50	1200	2400	7.8kg	3.5mm
21887	75 x 50	1200	2400	9.2kg	4mm
21896	100 x 100	1200	2400	6.1kg	4mm
21886	100 x 100	1200	2400	9kg	5mm

TREE GUARD

Whites Rural Tree Guard is a heavy duty enclosure to protect young trees. Tree Guard is rolled before delivery and arrive ready for installation.

Made in Australia to the highest standards, exclusively from Whites Albury Manufacturing plant in regional Australia, using premium grade wire.

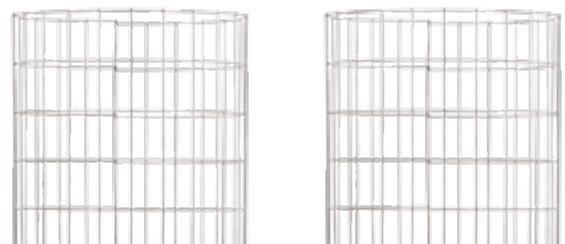

Code	Aperture (mm)	Diameter (mm)	Height (mm)	Length (mm)	Weight	Wire Dia.
TREE GUARD WELD MESH						
ATREE	160 x 100	750	1760	2400	11.2kg	5mm



Code	Wire	Tensile Strength	Coil Length	Coil Weight	Sling Qty	Coating	Rec. Tension Breaking Strain
AGRI-WIRE[®] TRELLIS WIRE							
10022	2.00mm	High	2000m	44kg	10	Hvy Gal	1.0kn, 2.7kn
10023	2.65mm	High	1000m	44kg	10	Hvy Gal	2.0kn, 6.0kn
10024	2.85mm	High	1000m	50kg	10	Hvy Gal	2.2kn, 8.3kn
10026	3.15mm	High	1000m	61kg	10	Hvy Gal	3.1kn, 9.4kn



Code	Product	Carton Qty
AGRI-WIRE[®] STRAINER		
12104	Agri-Wire Strainer	40

AGRI-WIRE[®] TRELLIS WIRE

Whites Rural Heavily Galvanised Agri-Wire High Tensile Trellis Wire is made in Australia to the highest standards, exclusively from Whites Albury manufacturing plant in regional Australia, using premium grade wire.

- Heavily galvanised to last up to 4 times longer
- Produced to the highest tolerance
- Smooth tangle free delivery



AGRI-WIRE[®] STRAINER

Whites Rural Agri-Wire Strainer is a specialised strainer for trellis wire in vineyards. Featuring a traditional cam-lock mechanism, the Agri-Wire Strainer's design makes it an easy and effective device for straining wire at the end of trellis.

Suitable for all high tensile wires up to 3.15mm and ideal for use with Whites Rural Agri-Wire Trellis Wire.

ACCESSORIES

Tools, Fencing & Tie Wire



FENCING PLIERS AND CUTTERS

Genuine Knipex® Quality

Knipex Professional Wire Cutting Plier made in Germany, from heat-treated Cr-V steel, with a tough cutting edge and a comfortable ergonomic design.

Genuine Toledo Pliers and Cutter

Durable and robust, designed for fencing. Made from chrome molybdenum steel and featuring specially heat-treated hardened jaws and cutting edges. Parrot-beak, bullnose and pocket cutter styles.

Fencing Pliers

Also available Whites general purpose range fencing pliers.



Code	Product	Size	Weight	Carton Qty
PROFESSIONAL PLIERS & CUTTERS				
12001	Knipex Professional Wire Cutting Plier	200mm	0.4kg	20
12041	Toledo Pocket Bolt Cutter	-	0.3kg	60
12042	Toledo Professional Parrot Beak Plier	270mm	0.7kg	24
12043	Toledo Professional Fencing Plier	260mm	0.5kg	36
12044	Toledo Professional Fencing Plier	300mm	0.8kg	24
FENCING PLIERS				
12002	Fencing Plier - Parrot Beak	250mm	0.6kg	5
12003	Fencing Plier - Bullnose	250mm	0.6kg	5
12004	Fencing Plier - Bullnose	300mm	0.7kg	5

FENCING ACCESSORIES

Fence Post Clips - Fixes plain or barbed wire to steel fence posts. Easy to use, each pack includes application tool.

Heavily Galvanised Pre-Cut Tie Wires

Easy to work with low tensile, pre-cut 300mm lengths. A great time-saver alternative to cutting longer coils to suit. Heavily galvanised & supplied in re-usable handy packs.

Horse-Safe Fence Post Caps - Hi-visibility and UV-resistant featuring three-slot pattern to hold 5mm hot wire and/or 12-40mm electric tape. White colour for horse safety. Suit standard 'Y' or larger intermediate posts.

Standard Post Caps - Unique Fin Grip™ system, snugly fits post with no need to tie down. With side holes for fence wire to pass through.

Stay Pins - Hot-dipped galvanised pre-cut 10mm rod lengths ideal for joining timber rails and posts. Long lasting, especially in CCA treated timbers. 300mm length for thicker timber and extra support.

Also available Whites pocket-sized fencing tool.



Code	Product	Per Packet	Weight	Carton Qty
FENCER'S TOOL				
12005	Fencer's Tool	-	0.1kg	-
FENCE POST CLIPS				
12319	Fence Post Clips (with tool)	250	1.4kg	8
HEAVILY GALVANISED PRE-CUT TIE WIRES				
71541	HG Pre-Cut Tie Wire 3.15mm x 300mm	approx 230	4kg	3
71543	HG Pre-Cut Tie Wire 2.50mm x 300mm	approx 340	4kg	3
HORSE-SAFE POST CAPS				
12348	Horse-Safe Post Caps	-	4.3kg	40
12349	Horse-Safe Post Caps XL	-	3.2kg	20
FENCE POST CAPS				
12322	Post Caps Yellow - 60mm	40	0.8kg	10
STAY PINS				
14340	Stay Pins Galvanised 10 x 300mm	50	9.5kg	

FARM PAK™ TIE WIRES

Whites Rural Farm Pak Tie Wires are wound onto a 'no tangle' dispenser pack for ease of use. The 3kg packs are light enough to carry yet contain sufficient wire for most applications around the farm.

- Heavily Galvanised Wire
- 'No tangle' dispenser
- Easy to handle 3kg packs
- Soft easy to tie



Code	Product	Length	Weight	Carton Qty
FARM PAK™ TIE WIRES				
50223	2.50mm Heavy Galvanised	80m	3kg	5
50224	2.00mm Heavy Galvanised	120m	3kg	5
50225	1.57mm Heavy Galvanised	200m	3kg	5

DRIVER, LIFTER & SPINNER

Contractor & Standard



CONTRACTOR GRADE

Contractor "Grip & Lift" Post Lifter

Robustly designed post lifter featuring parallel gripping surface with hardened steel grips. Heavy duty contractor grade construction.

- Hardened steel grips
- Suits most fence posts including Stockpost XL
- Galvanised steel; high tensile bolts

Contractor Post Drivers

Designed with reinforced handles and unique anti-shake handle to reduce vibrations transferred to the operator. Available in two sizes to suit standard posts and larger intermediate posts. Features include:

- Reinforced fully welded handles
- Balanced handles and head, reduces strain
- Anti-vibration collar

Three-Way Wire Spinner

Heavy Duty Three-Way Wire Spinner for smooth payout of plain & barbed wire. Zinc-plated, heavy duty steel construction. Made tough for Australian conditions.

Three different configurations make for an all-in-one tool to make fencing faster:

1. Fence Wire Spinner
Large diameter suits all fence wire types
2. Barbed Wire Spinner
Suitable for all types of barbed wire on reels
3. Mobile Hand-Cart
Turn unit on side for a mobile barbed wire hand-cart

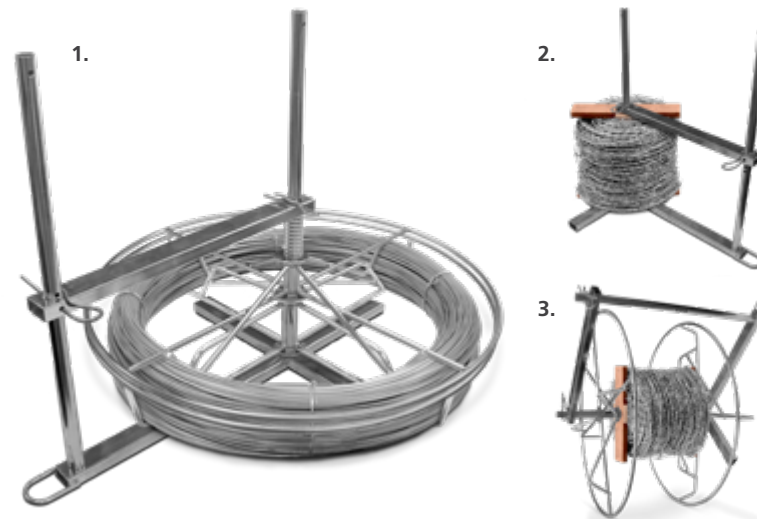

Code	Product	Weight
CONTRACTOR GRADE - LIFTER, DRIVERS & WIRE SPINNER		
12207	Contractor Grade 'Grip & Lift' Post Lifter	5.2kg
12203	Contractor Grade Post Driver	9kg
12205	XL Contractor Grade Post Driver	10kg
12111	Three-Way Wire Spinner	18kg

STANDARD

Whites Rural Standard range of lifter, driver and wire spinner are an economical alternative to the contractor range, available in a durable zinc-plated finish.

Post Lifter

Heavy steel construction. Simply place post in jaw and use the lever action to easily remove steel posts.

Post Driver

Heavy steel construction, weighted balanced head.

Fence Wire Spinner

Central hub is designed for smooth, easy payout, and is adjustable to reduce spin and overrun for faster payout. Includes barbed wire attachment.



Code	Product	Weight
STANDARD - LIFTER, DRIVER & WIRE SPINNER		
12200	Post Lifter	8.3kg
12201	800mm Post Driver	6.8kg
12110	Wire Spinner	11.5kg

STRAINERS

Straining Tools & Wire Strainers

STRAINING TOOLS

Whites Rural offers a wide range of both temporary and permanent wire strainers. Proven designs that are hard wearing and built to last.

Wire Chain Strainer

Whites Rural Chain Strainer is a proven design with hard wearing features, built tough to last.

The smooth-grip jaws hold all common sizes of fence wire while minimising wire damage.

The rugged steel handles are gold passivated for superior protection. Also includes a gold passivated standard tested chain with swivel and heavy duty rivets.

Fabricated Farm Fencing Strainers

Used with a chain strainer, it allows for easy straining and installation of fabricated farm fencing. 1.6m - ideal for exclusion fencing.

Length	1.2m	1.6m
Clamping Points	4 wedged pegs	6 wedged pegs
Straining Points	3	5



12302

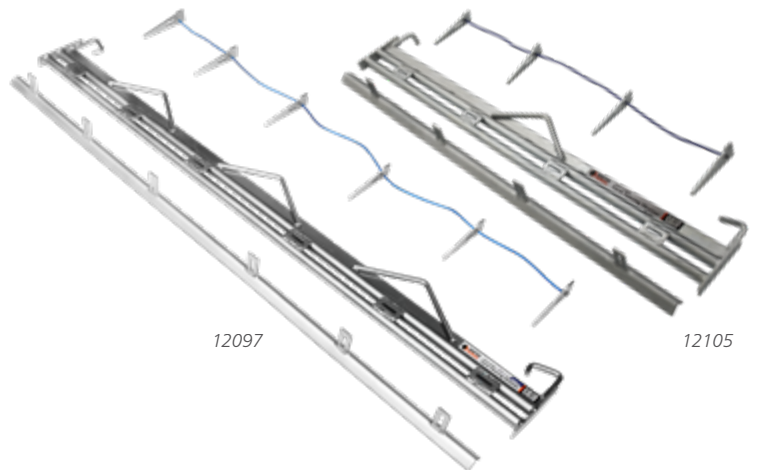

12097

12105

WIRE STRAINERS

Permanent Wire Strainers

The easy solution for fence erecting, wire alignment & fence maintenance fast and easy. Attach to fence line and tighten to strain. Permanent wire strainers stay on the fence line and can be re-tightened over time to prevent wire sag.

- Strainers made in New Zealand
- Galvanised steel
- Smooth ratchet action
- Standard and insulated available



Code	Product	Weight
STRAINING TOOLS		
12302	Contractor Chain Strainer	3.8kg
12105	Contractor Fabricated Farm Fencing Strainer 1.2m	9.1kg
12097	Contractor Fabricated Farm Fencing Strainer 1.6m	13kg
12109	Replacement Wedge Pack (1.2m)	0.65kg

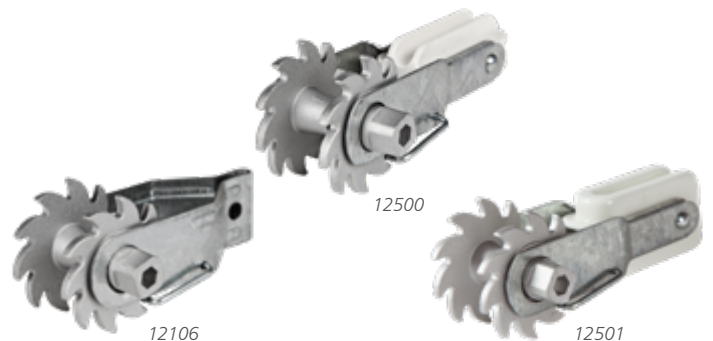

12106

12500

12501

Code	Product	Pack Qty
PERMANENT WIRE STRAINERS		
12106	Permanent Wire Strainer	25
12500	Insulated Perm. Wire Strainer - Plastic	20
12501	Insulated Perm. Wire Strainer - Porcelain	20
12099	Permanent Wire Strainer	25
12090	Permanent Wire Strainer - Bucket	40

STAPLING

Cordless Impulse Power



ST400i



ST400i Impulse Fencing Staples
& Fuel Cell Pack



ST315i



ST315i Impulse Fencing Staples
& Fuel Cell Pack

Code	Product	Per Packet	Weight
STOCKade[®] IMPULSE[®] POWER STAPLING			
12440	STOCKade ST315i Impulse Power Stapler		6.6kg
12441	STOCKade 33 x 3.15mm Impulse Barbed Staples	2000	6.7kg
12453	STOCKade 40 x 3.15mm Impulse Staples	2000	7.2kg
12445	STOCKade ST400i Impulse Power Stapler		4.2kg
12446	STOCKade 40 x 4.0mm Impulse Barbed Staples	1000	7.75kg
12448	STOCKade 50 x 4.0mm Impulse Barbed Staples	1000	10.2kg
STOCKade[®] IMPULSE[®] FENCING ACCESSORIES			
12439	STOCKade ST315i Battery		0.09kg
12449	STOCKade ST400i Battery		0.09kg

STOCKade[®] Impulse[®]

STOCKade Impulse power staplers combine faster fencing with hose-free portability in a gas cartridge gun.

ST400i Impulse Power Stapler

The ST400i has outstanding power allowing you to fire up to 650 staples per fuel cell and in conjunction with the 3.7V Li-ion battery, you can fire 3000 barbed, divergent point staples per charge per battery.

The ST400i kit also comes with 2 batteries so you will never run out of power.

- Impulse technology
- Ergonomic design
- Adjustable depth of drive
- Top load magazine
- V-notch guide and sequential trigger system



ST400i staples and fuel cell packs, each pack contains 2 fuel cells, enough for every staple in the pack. Available in 40mm & 50mm, with a 4mm wire diameter.

- Divergent point barbed fencing staple
- Zinc-Aluminium coating for longer life
- Superior driving and improved holding

ST315i Impulse Power Stapler

Driving 3.15mm staples at a rate of up to 2 staples per second, the unit is lightweight and comfortable and there is no need for an air compressor.

ST315i staples and fuel cell packs, each pack contains enough fuel for every staple in the pack. Available in 33mm & 40mm, with a 3.15mm wire diameter.

STOCKade
makes fencing

Exclusively distributed in Australia by Whites Rural

STAPLING

Pneumatic & Manual

STOCKade® Pneumatic

The STOCKade pneumatic power stapler is designed for faster fencing and reduced manual effort.

The ST400 Pneumatic Power Stapler is engineered specifically for driving heavy-duty barbed fencing staples up to 50mm long.

- Dramatically increases stapling speed and productivity
- Aluminium alloy housing for extreme durability
- Adjustable power for high density timber

The world's only power-driven barbed staple for superior holding power.

- Available in 45mm & 50mm - 4mm wire diameter
- Heavy Zinc-Aluminium Bezinal® 2000 coating
- Divergent point staples

STOCKade
makes fencing

Exclusively distributed in Australia by Whites Rural



ST-400

Code	Product	Per Packet	Weight
STOCKade® PNEUMATIC POWER STAPLING			
12430	STOCKade ST400 Power Stapler		6.6kg
12454	STOCKade 50 x 4.0mm Barbed Staples	1000	10kg

FENCING STAPLES

Galvanised double pointed "U" nail for securing wire to timber frames and posts. Plain or barbed staples for added holding power.

- Galvanised for maximum durability
- Razor sharp points for fast, easy driving
- Suitable for securing wire, mesh and netting

Available in Hot-dipped galvanised for longer life.



Code	Product	Qty Per Packet	Weight	Carton Qty
GALVANISED STAPLES				
12503	50 x 4.0mm Barbed	50	500g	24
12509	40 x 4.0mm Barbed	52	500g	24
12513	30 x 4.0mm Barbed	65	500g	24
12416	25 x 3.15mm Plain	132	500g	24
12502	50 x 4.0mm Barbed	300	3kg	8
12506	40 x 4.0mm Barbed	315	3kg	8
12512	30 x 4.0mm Barbed	390	3kg	8
12412	25 x 3.15mm Plain	795	3kg	8
12517	50 x 4.0mm Barbed	1500	15kg	1
12518	40 x 4.0mm Barbed	1600	15kg	1
HOT-DIPPED GALVANISED STAPLES				
12504	50 x 4.0mm HDG Barbed	500	5kg	4
12510	40 x 4.0mm HDG Barbed	575	5kg	4
12505	50 x 4.0mm HDG Barbed	1500	15kg	1
12511	40 x 4.0mm HDG Barbed	1600	15kg	1



FASTENERS

Pneumatic & Manual



STOCKade[®] RINGfast[™]

The RINGfast pneumatic ring fastening tool quickly and consistently secures ring fasteners.

Faster than manual tools, reliable and relatively effortless, the pneumatic operation produces consistent rings fast, reducing manual effort and improving productivity.

The tool has been designed with an ergonomic grip and is balanced for comfortable operation.

- Quickly and consistently secures ring fasteners
- Reduces manual effort, improves productivity
- Ergonomic and comfortable to operate
- Zinc-Aluminium coating for longer life



JAMBRO[®] RING FASTENER

Whites Rural exclusively distributes the Jambro Ring Fastener Gun and Clips in Australia. Fast and reliable, this manual gun will fasten to a rate of 25 metres per minute.

The stainless steel jaws and precision body casting ensure quick and easy loading and firing. Use with Jambro high tensile ring clips.

- Faster fencing, 25 metres per minute
- Stainless steel jaws
- High tensile ring fasteners
- Zinc-Aluminium coating for longer life

Code	Product	Per Packet	Weight
STOCKade[®] RINGFAST[™] PNEUMATIC RING FASTENERS			
12308	STOCKade RINGfast Pneumatic Tool (bonus case)		1.5kg
12305	STOCKade RINGfast Ring Fasteners	1000	0.7kg
STOCKade[®] JAMBRO[®] RING FASTENERS			
12300	Jambro Ring Fastener Gun		0.4kg
12301	Jambro Standard Ring Fasteners	1000	1kg



Code	Product	Per Packet	Weight	Carton Qty
WOOL BALE FASTENERS				
12330	Wool Bale Fasteners	100	500g	24
12331	Wool Bale Fasteners	300	1.5kg	8
12334	Wool Bale Fasteners	700	3.5kg	4
12335	Wool Bale Fasteners		15kg	1

WOOL BALE FASTENERS

Super sharp, galvanised and pressed cut to ensure the finest point. Penetrates fabric first time.

Designed to be used in conjunction with Australian Wool Exchange (AWEX) standards.

MaxTensor®

Wire Joining, Tensioning & Terminating

MAX Engineering

Exclusively patented system, *MaxTensor's* all metal construction is designed for maximum quality, reliability and ease of use when joining and tensioning wire.

MAX Usability

Ergonomically designed for effortless practicality and long lasting performance, *MaxTensor* makes joining, straining and repairing fences easier.

MAX Reliability

With millions sold globally, *MaxTensor's* patented system is industry tested and proven against the best the world has to offer. Made in the EU to strict specifications.

Exclusively distributed throughout Australia & New Zealand by Whites Rural.



Barbed Wire - MaxTensor
Medium Joiner & Tensioner will fit up to 1.57mm barbed wire.



High Tensile Wire - MaxTensor
is specially designed for wire with a high breaking strain.



Electric Fencing - MaxTensor's
all metal construction means there is no break in the current.



Zinc Aluminium - MaxTensor's
cam wedge provides a strong grip to hold Zn Al coated wire.

All Metal Construction

**Joiners & Terminators
for fencing wire,
horticultural wire &
fabricated fence**



MaxTensor is a complete range of joiners, tensioners, end post terminators and tensioning tools



12157



12159



12152



12160

12161

Code	Product	Per Packet	Carton Qty
MaxTensor® WIRE JOINERS & TENSIONERS			
12157	MaxTensor Medium Joiner - Blister Pack	20	6
12156	MaxTensor Medium Joiner - Contractor Pack	100	2
12155	MaxTensor Medium Joiner - Bulk Pack	250	-
12159	MaxTensor Large Joiner - Blister Pack	10	6
12158	MaxTensor Large Joiner - Bulk Pack	150	-
MaxTensor® WIRE TERMINATORS & TENSIONERS			
12152	MaxTensor Medium Terminator - Blister Pack	10	6
12151	MaxTensor Medium Terminator - Bulk Pack	300	-
MaxTensor® TENSIONING TOOLS (WITH 5 BONUS MEDIUM JOINERS)			
12160	MaxTensor Polymer & Steel Core Tensioning Tool		
12161	MaxTensor Heavy Duty Steel Tensioning Tool - Contractor Grade		



Whites Group Pty Ltd

ABN 25 001 845 478

SYDNEY

5 Dolerite Way
Pemulwuy, NSW 2145

BRISBANE

Unit 4, 15 Seeana Place
Heathwood, QLD 4110

MELBOURNE

64 Colemans Road
Dandenong South, VIC 3175

TOWNSVILLE

13 Crocodile Crescent
Mt St John, QLD 4818

PERTH

53 Collopy Road
Perth Airport, WA 6105

ADELAIDE

18 Bradford Way
Cavan, SA 5094

Enquiries: 1300 559 732 Fax: 1300 559 762 Email: info@whitesrural.com.au
Specifications referred to in this publication are subject to change,
variation and/or improvement without notice.

For the most up-to-date details on all our rural products, visit our website at
www.whitesrural.com.au

© WHITES RURAL, STOCKPOST, UTE PACK, STIFF STAY, FRAUENFELDER and Agri-Wire are registered trademarks of Whites Group Pty Ltd
™ TOP NOTCH, FARM PAK, FARMLITE, HANDYFENCE, FIN GRIP and RINGfast are trademarks of Whites Group Pty Ltd

© MaxTensor is a registered trademark of Shiny Works, S.L. © STOCK-ade, Impulse & Jambro are registered trademarks of Paslode Pty Limited
© Knipex is a registered trademark of KNIPEX-Werk C. Gustav Putsch KG © Bezinal is a registered trademark of NV Bekaert SA

© FAMOUS TOLEDO EXCELLENCE BY DESIGN is a registered trademark of Tridon Australia Pty Ltd